

| MATERIAL KEY - HERITAGE PARK  |   |
|-------------------------------|---|
| Type Mark                     | Description   |
| <b>LANDSCAPE STRUCTURES</b>   |   |
| LS-1                          | ALLEY GATEWAY SIGNAGE   |
| LS-6                          | PLAY STRUCTURE  |
| LS-7                          | FLAG POLE (APPROX LOC)  |
| <b>LANDSCAPE WALLS</b>        |   |
| W-1                           | 6" CIP CONC CURB, SCD   |
| W-2                           | METAL WALL  |
| W-7                           | CONCRETE AND WOOD SEAT STEPS WITH BUILT IN BENCHES                |
| W-9                           | CONCRETE SEATWALL PLANTER W/ BUILT-IN METAL WALL PLANTING POCKETS |
| W-10                          | CONCRETE SEATWALL PLANTER   |
| <b>LIGHTING</b>               |   |
| L-2                           | CATENARY SYSTEM POST  |
| L-4                           | EXISTING ACORN LUMINAIRE  |
| L-5                           | EXISTING STREET LIGHT   |
| <b>MISC</b>                   |   |
| W-1                           | 6" CIP CONC CURB, SCD   |
| W-2                           | METAL WALL  |
| <b>PAVING</b>                 |   |
| P-1                           | UNIT PAVING TYPE 1  |
| P-2                           | CIP CONC SIDEWALK   |
| P-3                           | ASPHALT PAVING  |
| P-4                           | CIP CONC FLUSH CURB   |
| P-6                           | SYNTHETIC TURF PLAYGROUND SAFETY SURFACING                        |
| <b>PLANTING</b>               |   |
| PA-1                          | PLANTING AREA - IN GRADE  |
| PA-2                          | PLANTING AREA - IN RAISED METAL WALLS                             |
| PA-3                          | ROOT BALL   |
| PA-B                          | BIORETENTION PLANTING AREA  |
| PA-R                          | ROOT BALL   |
| S1                            | SHRUB   |
| S2                            | SHRUB   |
| T-GB                          | PRINCETON SENTRY GINKGO   |
| T-PO                          | AMERICAN PLANE TREE   |
| <b>SITE FURNISHINGS</b>       |   |
| SF-3                          | MOVEABLE CHAIR  |
| SF-4                          | MOVEABLE TABLE  |
| SF-6                          | LOUNGE SEATING  |
| SF-8                          | WAYFINDING IDENTITY SIGNAGE W/ BUILT IN BAR TOP                   |
| <b>STAIRS &amp; HANDRAILS</b> |   |
| S-1                           | CIP CONCRETE MONUMENTAL STAIR W/ HANDRAILS                        |
| S-2                           | CIP CONCRETE STAIR W/ HANDRAILS                                   |

Owner/Developer:  
 CITY OF SUMNER WASHINGTON  
 City of Sumner  
 1104 Maple Street  
 Sumner, WA 98390  
 (253) 299-5700

Landscape Architect:  
 JETT LANDSCAPE ARCHITECTURE + DESIGN  
 JETT  
 3445 California Ave SW  
 Seattle, WA 98116  
 (206) 909-3890

Engineer:  
 JMTEAM  
 JM1 Team  
 905 Main Street, Suite #200  
 Sumner, WA 98390  
 (206) 596-2020

Project:  
 Heritage Park

ONE INCH AT FULL SCALE.  
 IF NOT, SCALE ACCORDINGLY

CUP Submittal

REVIEW #1  
 CUP-2024-0005

| REV | DATE | DESCRIPTION |
|-----|------|-------------|
|     |      |             |
|     |      |             |
|     |      |             |
|     |      |             |
|     |      |             |
|     |      |             |
|     |      |             |
|     |      |             |
|     |      |             |

SHEET TITLE

**CUP SITE PLAN**

PROJ. NO.:  
 DATE: June 21, 2024

DRAWN BY: MM DESIGN BY: TB

SHEET NUMBER

**L1.01**

DWG. \_\_\_\_\_ OF \_\_\_\_\_ XX



| SITE AREA |                      |
|-----------|----------------------|
| Area      | Name                 |
| 29,859 SF | HARDSCAPE / BUILDING |
| 2,344 SF  | LANDSCAPING          |
| 32,203 SF |                      |

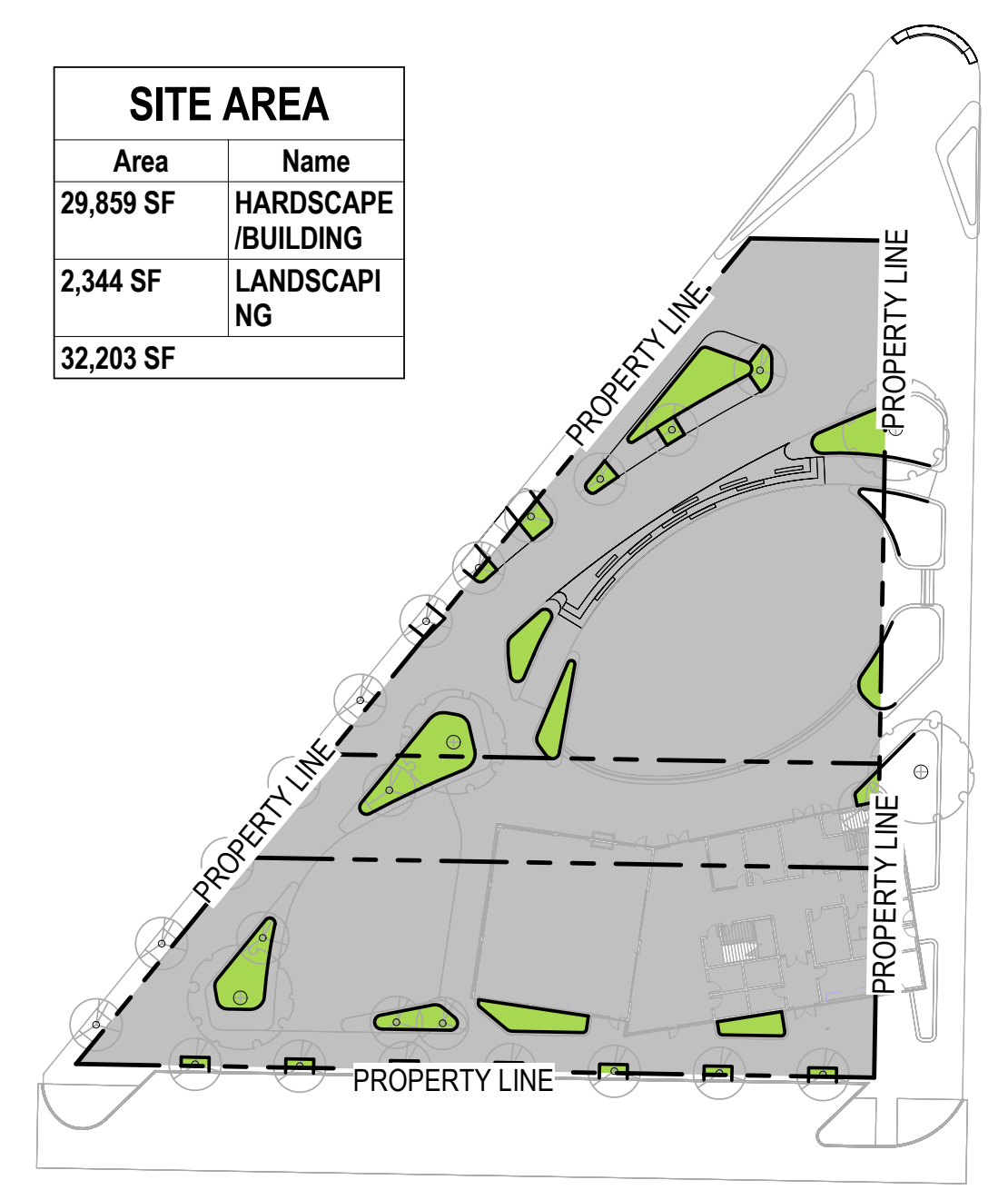

**1** PARK-SEPA & CUP SITE PLAN  
 1" = 20'-0"

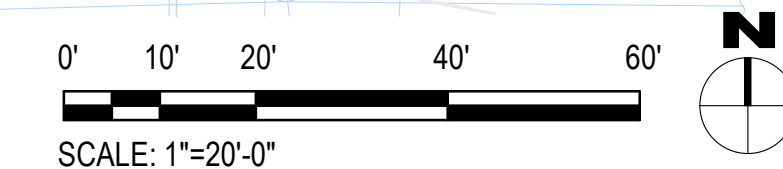

**2** LANDSCAPING/HARDSCAPE TAKEOFFS  
 1" = 50'-0"

CALL TWO BUSINESS DAYS BEFORE YOU DIG  
 1-800-424-5555  
 UTILITIES UNDERGROUND LOCATION CENTER